



**Our community would like to Invite  
Team Georgia and  
2013/2014 Little Kids State to Dalton.**



NORTHWEST  
GEORGIA

trade and convention center

*elevate your experience*





# NORTHWEST GEORGIA TRADE & CONVENTION CENTER

2211 Dug Gap Battle Road

Dalton, GA • 30720

(706) 272-7676

<http://www.daltontradecenter.com>



**The facility is 1/4 mile from Interstate  
75 at exit 333 in historic Dalton, GA.**

After exiting I-75 at Exit 333, turn West onto Walnut Avenue. Continue 1/4 mile up the hill and turn left into the convention center parking lot.











# Where is Dalton, Georgia?

Dalton is conveniently located right off Interstate 75 in northwest Georgia.

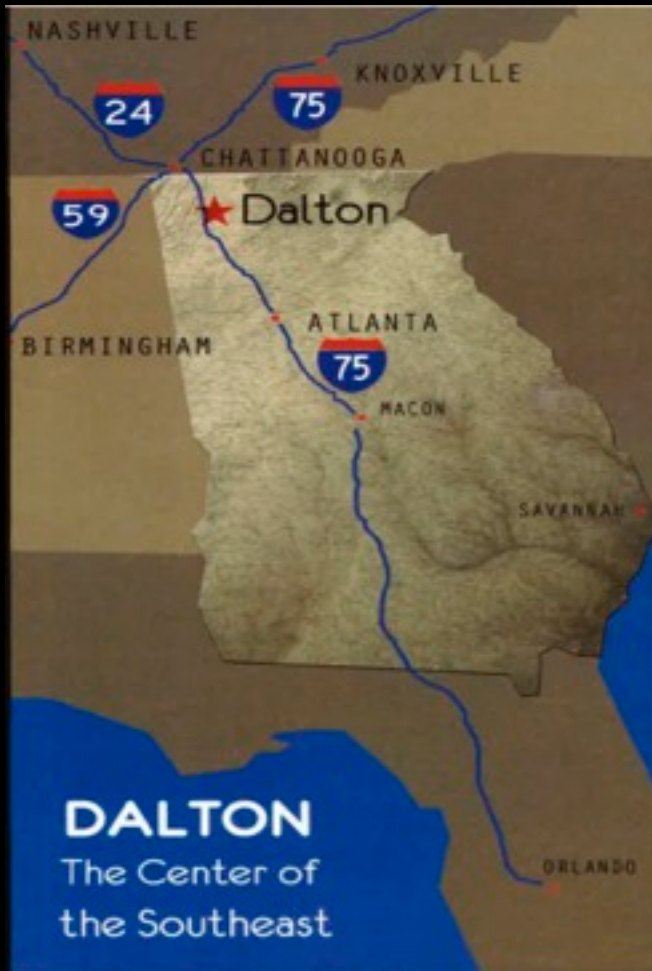

Dalton is just a short drive away!

Chattanooga...33 miles

Rome.....47 miles

Atlanta.....90 miles

Columbus.....193 miles

Augusta.....235 miles

Valdosta.....318 miles

Savannah.....338 miles



## Sample Accommodations



Holiday Inn and Suites (full service hotel)	110 Rooms
Country Inn and Suites	68 Rooms
Courtyard by Marriott	93 Rooms
Hampton Inn	124 Rooms
Holiday Inn Express	71 Rooms
La Quinta Inn and Suites	84 Rooms
Howard Johnson	60 Rooms
Quality Inn	70 Rooms
America's Best Inn	90 Rooms



Dalton has over 1,600 hotel rooms that can fit in a wide variety of budgets.  
No hotel is over 2 miles from the Northwest Georgia Trade & Convention Center.

# Restaurants



Outback Steakhouse

Zaxby's

Chili's

Irongate Pizzeria

O'Charley's

The Dalton Depot

Applebee's

Tiajuana's

Shoney's

El Sombrero

Red Lobster

Oakwood Cafe

Longhorn Steakhouse

The Coffee Train

Panera Bread

Chik-fil-a

Fuji Steak & Sushi

Steak and Shake

Las Palmas

Kem's Restaurant

# Outline

- **Tournament Director** - Michael Keefe Dalton HS Wrestling Coach, 2005 NCAA All-American at the University of Tennessee-Chattanooga. and former Dade County head wrestling coach. Originally from Ringgold, Georgia.
- **Tournament Consultant** - Levi Burdick, Chattooga Wrestling
- **Tournament Host Club** - Grindhouse Wrestling and Head Coach Matt Pitts
- **Volunteer Organizations** - Grindhouse Wrestling School, Dalton State College Athletic Department, Dalton High School Wrestlers and Boosters, Northwest Whitfield High School Wrestlers and Boosters, Southeast High School Wrestlers and Boosters, Cohulla Creek High School Wrestlers and Boosters, Morris Innovative High School Wrestlers. (All these organizations have agreed to provide mats, table volunteers and support to help run the tournament including scales for weigh-ins. )
- **Volunteer Table Workers** - We have 26 committed adult volunteers with wrestling backgrounds to help manage the 13 tables/mats and work with the local high school volunteers. None of these individuals have youth wrestlers that would be participating.
- **Security** - City of Dalton and County of Whitfield will provide uniformed officers for the event and parking. The Trade Center has barriers that will be used to secure the mat areas like never before. (Photo in later slide)
- **Electronics** - Dalton High School will provide **13 Laptops** to be used at each scorers table with WiFi to run the event live on Track and on flat screen televisions within the facility to keep wrestlers and coaches up to date on where matches are on each mat in live real time.
- **Food** - There will be multiple points of access for fans for concessions. Food will be traditional event food plus smoothies and can customize based on what team georgia wants to serve.
- **Hospitality** - This will be a special box/room that overlooks the main arena with a back door that is on the up stairs floor to provide easy access to the 3 mat 6u room. There will be a very wide variety of nice food and drinks available for all. We can also customize based on needs of team georgia.
- **Healthcare** - Hamilton Medical Center will provide one EMT Unit on location and a trainers table incase of any injuries and to help handle nose bleeds and other incidentals.
- **Vendors** - We have to ideas for vendors in the halls or we can use a banquet room/vendor room ~~q11~~ to not crowd the walking areas.



# Plan

**Weigh-Ins** - 5 to 8 pm (doors **will not** open early) Advance tickets sales (all family members must be present to get the family rate) Bronze Card Passes will be handed out at the same time. There will be a morning option from 7 to 7:30. There will be 6 scales used( 2 per age group) and 3 check weight scales. We will run this in the upstairs ball room to control entry and exit for the kids safety and organization. This is the same room that we will run all 6U on 3 mats.

**Mat Plan:** Each of the 13 mats will have a corner with a Red Carpet Triangle and a Green Carpet Triangle. There will be two chairs on each piece of carpet for coaches to sit and coach their wrestler. Coaches will sit on corresponding color to their wrestlers band and only two coaches will be allowed per corner.

**Building Organization:** All 8U & 10U will be in the main room with 10 mats. We would run all 6U in the upstairs ballroom on the 3 mats. There is a 250 seat auditorium to run coaches and referee meetings.

**Finals/Medal Rounds:** We would run all finals on 6 mats in the main room and expand seating capacity as we shrunk the number of mats to over 2,000. We could bring down the lights and have music and smoke to bring the wrestlers out to. really make it a professional show for them.

**Medal Awards:** During the finals we would organize the upstairs ball room with the platforms and awards. We would bring each age group to the ballroom at one time to control the mass of people and make it easier on parents and coaches to see, hear and take photos.

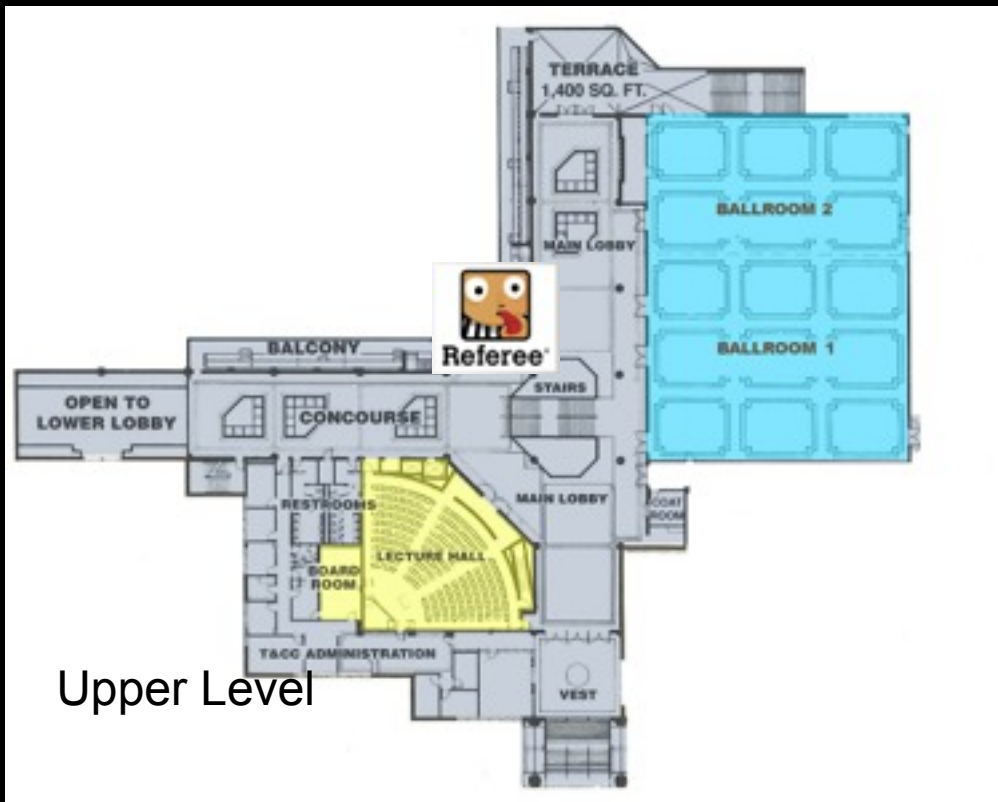

Upper Level

Coaches and Referee  
Hospitality Suite  
overlooking the arena.  
Sample hospitality food  
items.



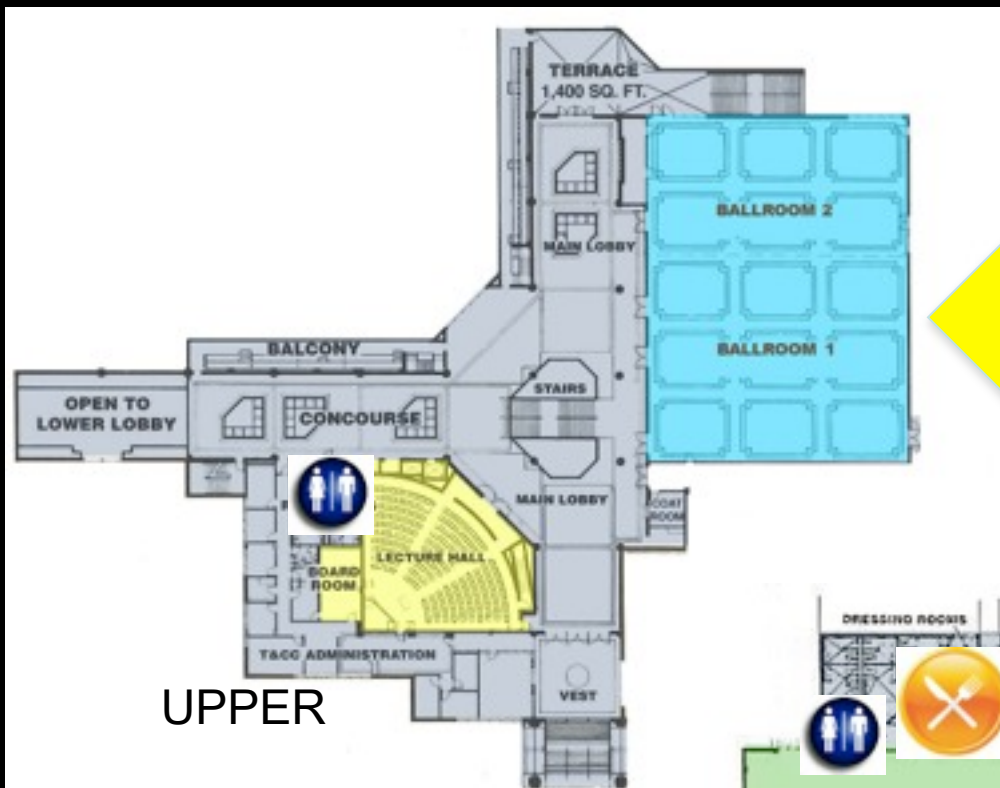

UPPER

3 Mat Ballroom

10 Mat Arena

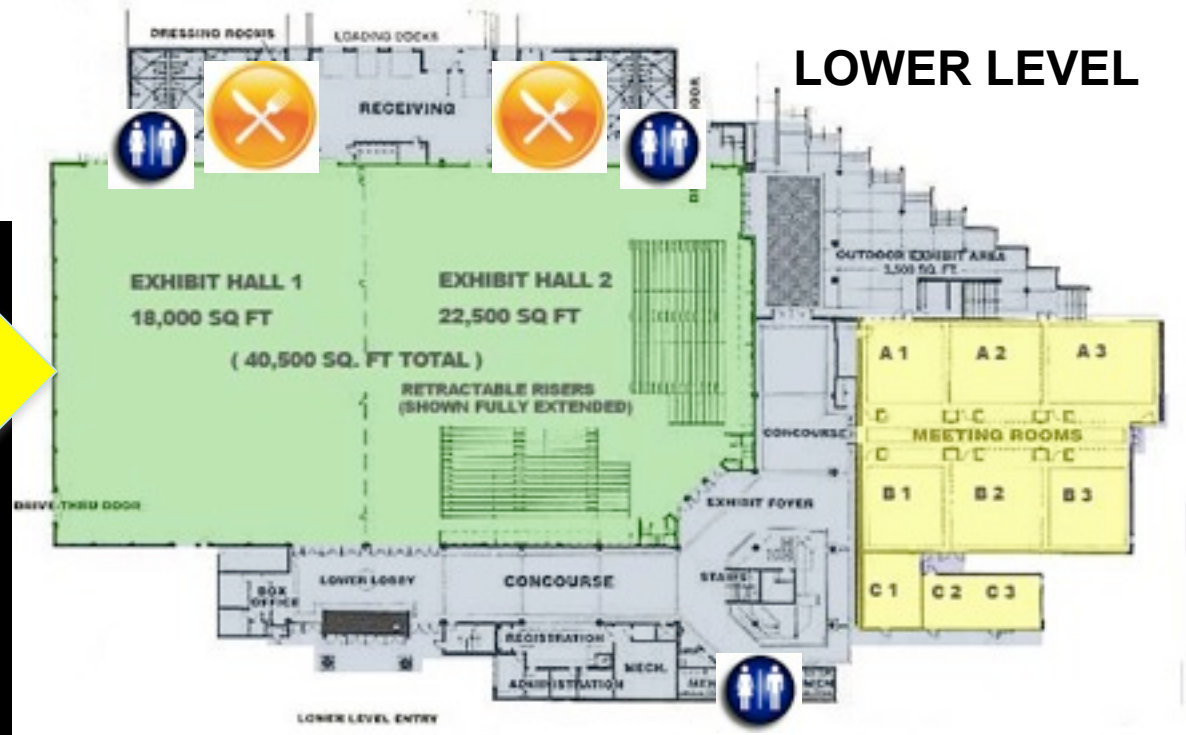

LOWER LEVEL

LOWER LEVEL ENTRY



## All 8u & 10u matches and Medal rounds

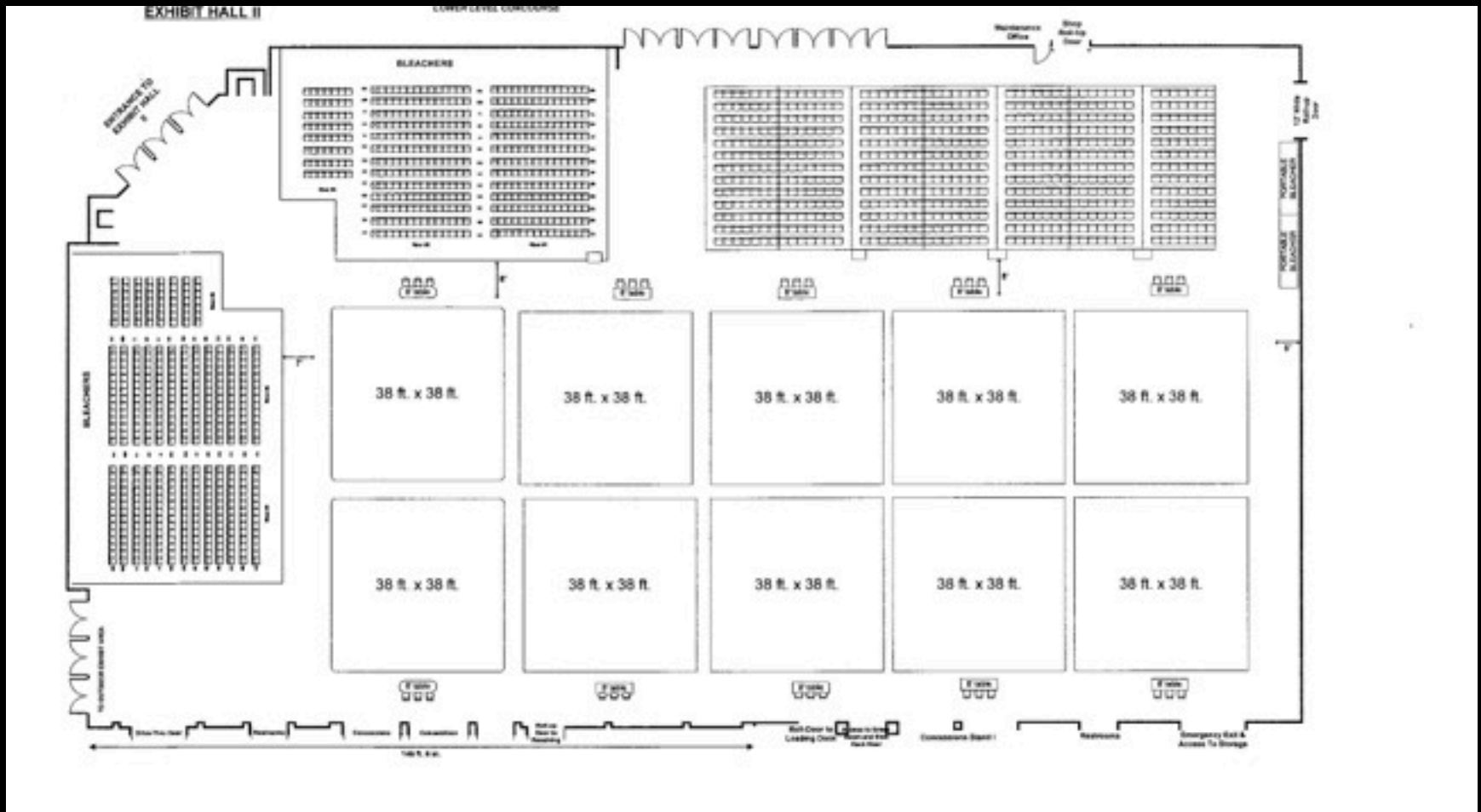

# 3 Mat Ballroom Layout

Approximately 600 seating capacity

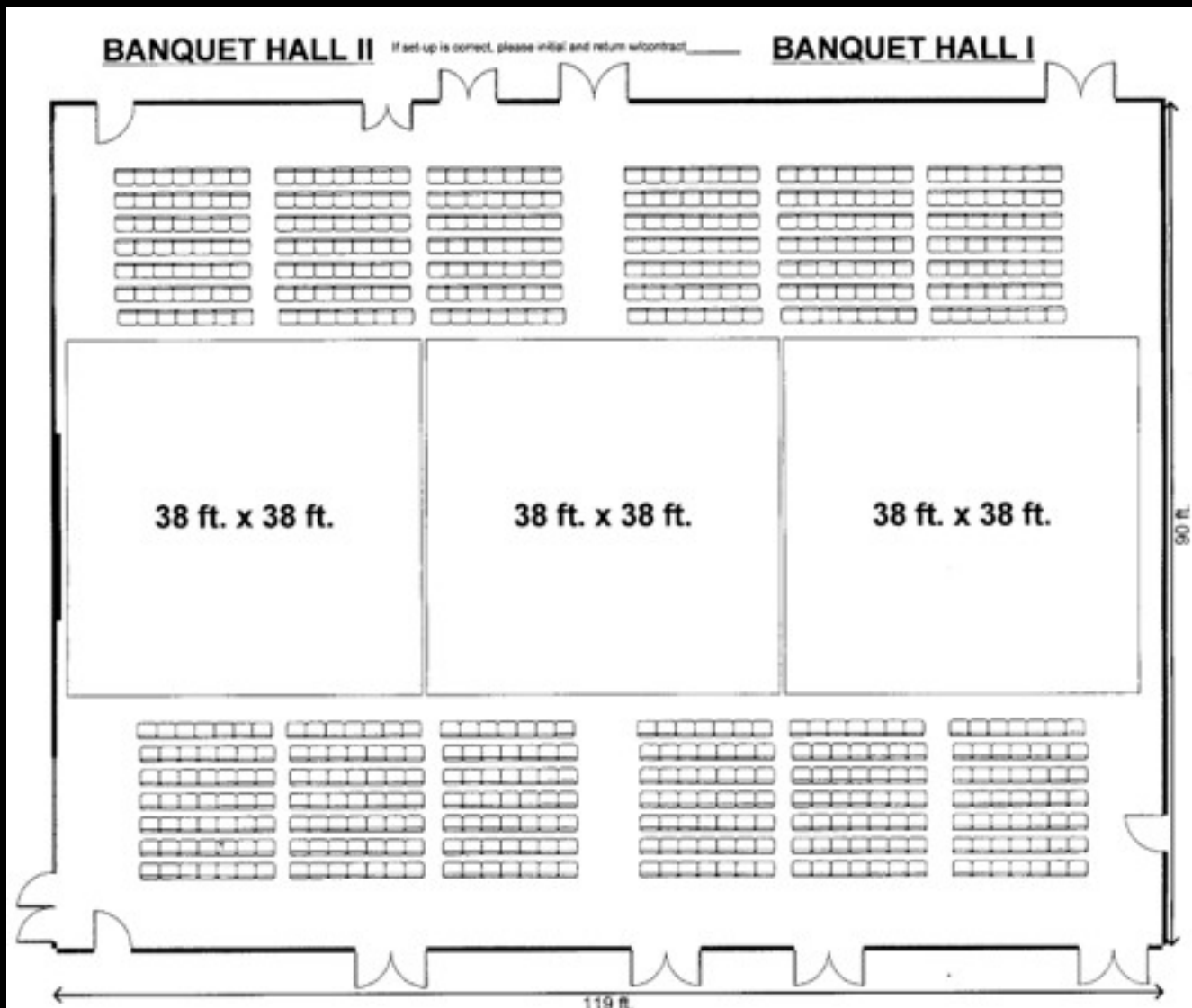

# Sample Security Barrier to secure the mats

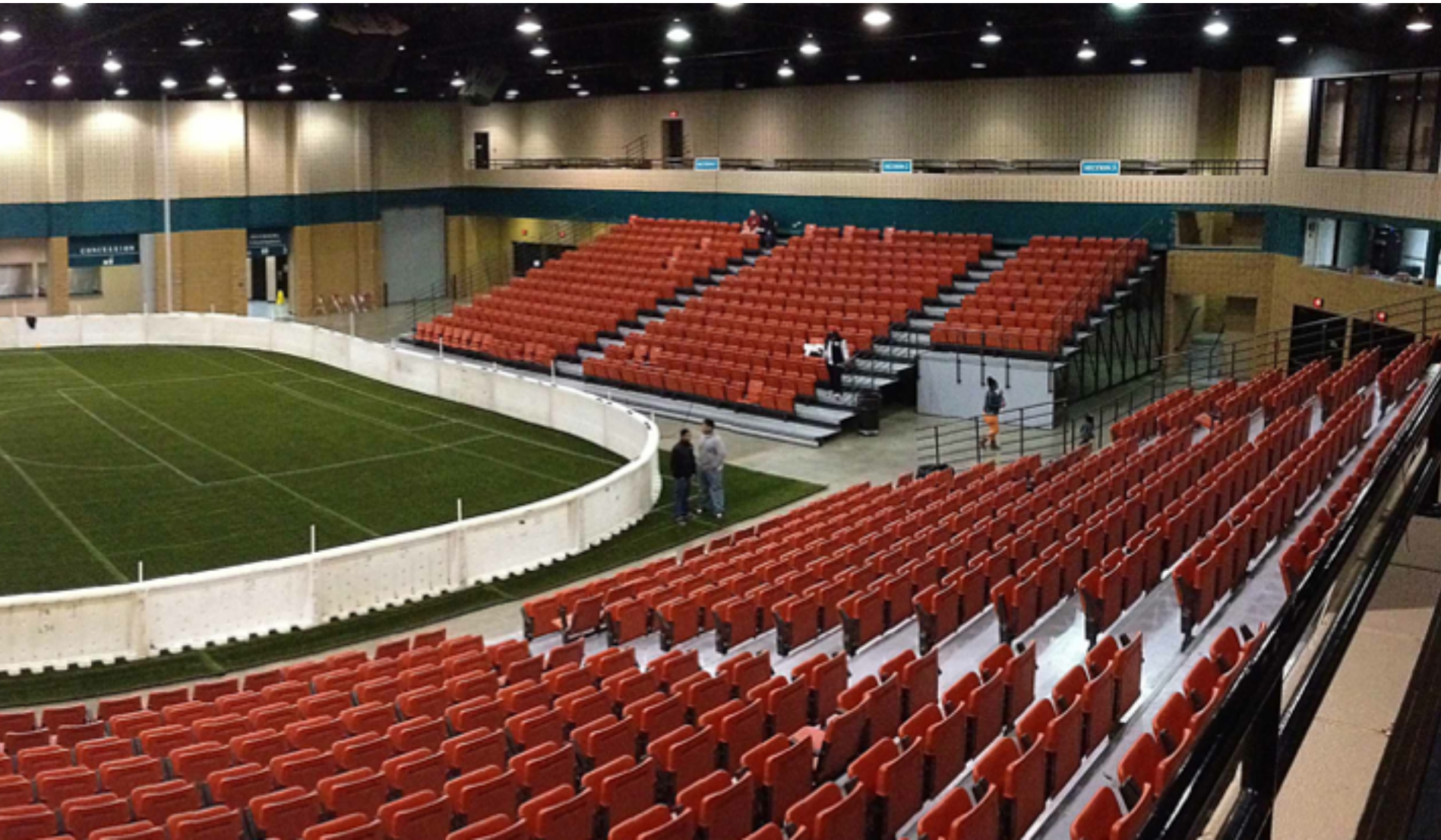



# National Collegiate Wrestling Association 2013 National Duals



# Financial Offer

- The Trade Center will act as any high school would in the revenue splits. The only added additional expense would be for Team Georgia to handle the Referee Fees. All other revenue splits between our facility and Team Georgia would stay the same as they have been in past years. Our goal is to return any and all cash profits back to area clubs and high schools for their programs to grow. This is a true community event.

*We hope to see you in  
Dalton in 2014!*