

How to Add a Family Member to Team Communication in SportsEngine

Step 1: Account Owner - Click the **Blue Button** with your initials in the upper right corner of the Screen. Then click **Account Settings**

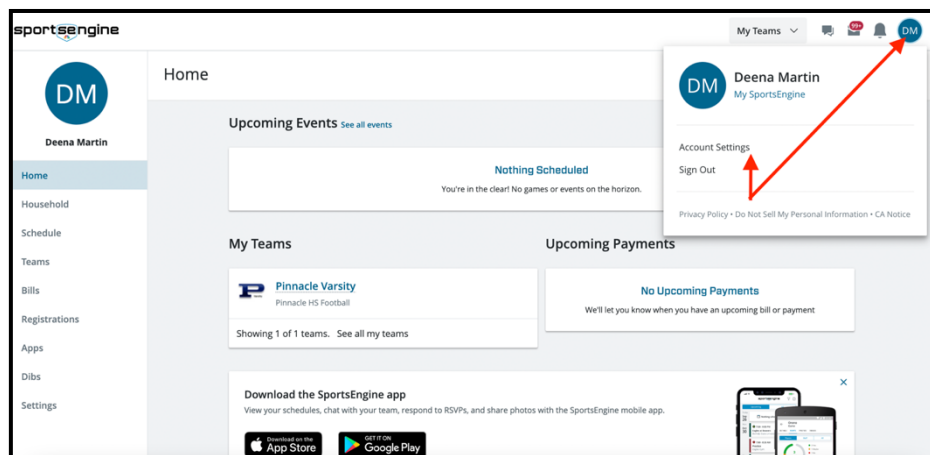

Step 2: Tap **Edit** next to the Account Owner's email address.

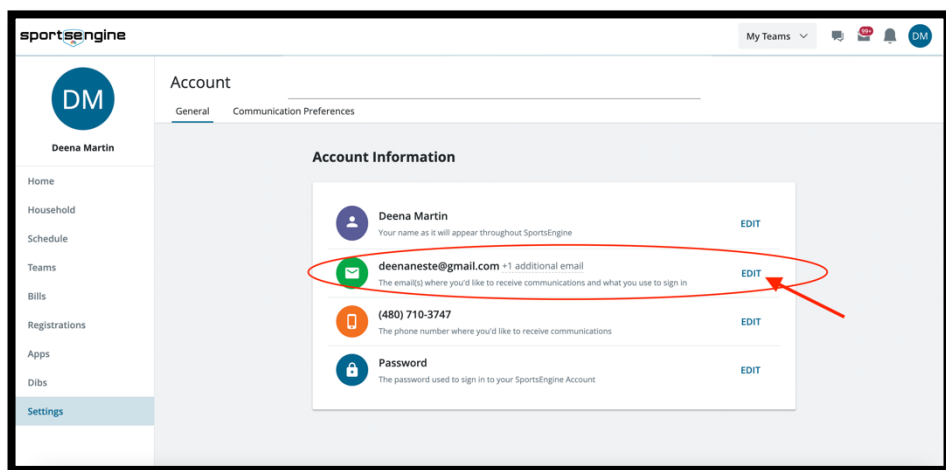

Step 3: Tap **Add Email**. SportsEngine will send an invite to the newly added email addresses requesting verification.

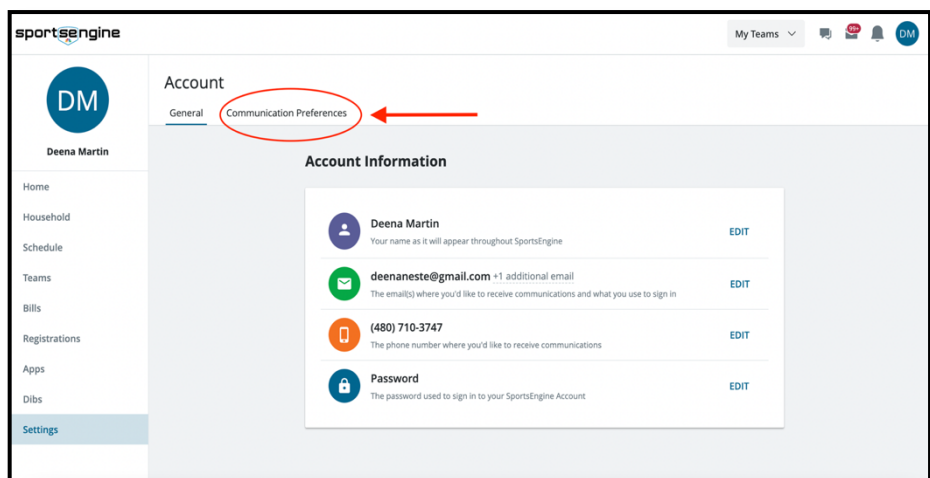

Step 4: Once the email has been “Verified” go to **Settings > Communication Preferences**.

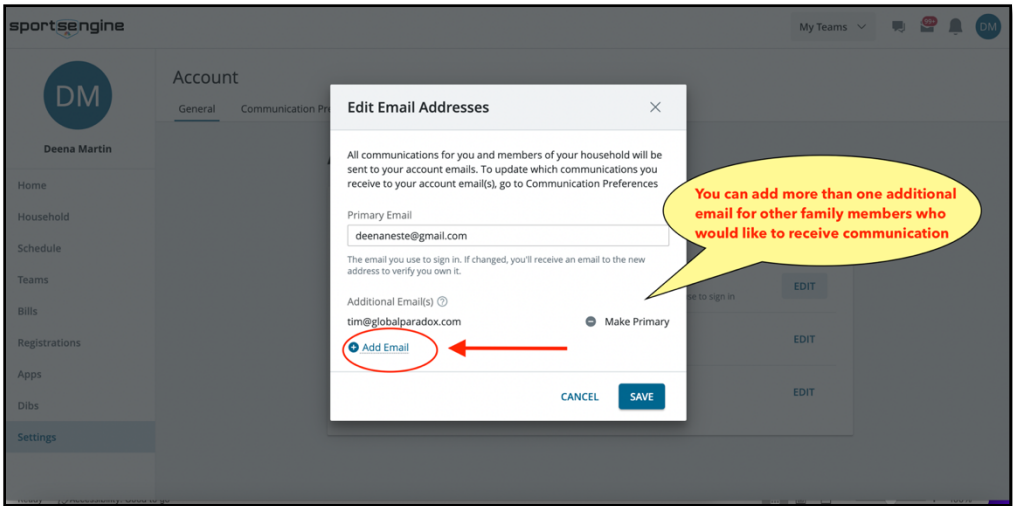

Step 5: Click the boxes to select the email addresses for each individual who would like to receive Team Communication.

